

## Schalldämm-Mass

# 4351

mm kg/m<sup>2</sup>

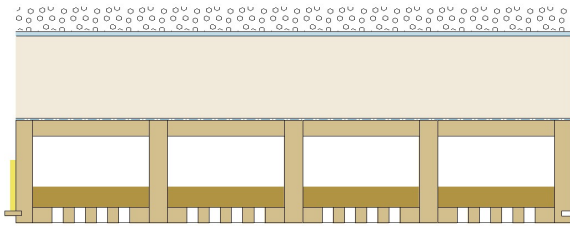

Kies	50	76
Elastomerbitumenbahn zweilagig	8	10
Bauder ECO F	160	5
Dampfbremse Bauder TEC KSD FBS	3	3
LIGNATUR Flächenelement	200	39
REI30		
Akustik Typ 3.1		4
	421	137

$$R_w (C ; C_{tr}) = 55 (-1 ; -5) \text{ dB}$$

( C = C<sub>100-3150</sub> ; C<sub>tr</sub> = C<sub>tr,100-3150</sub> )

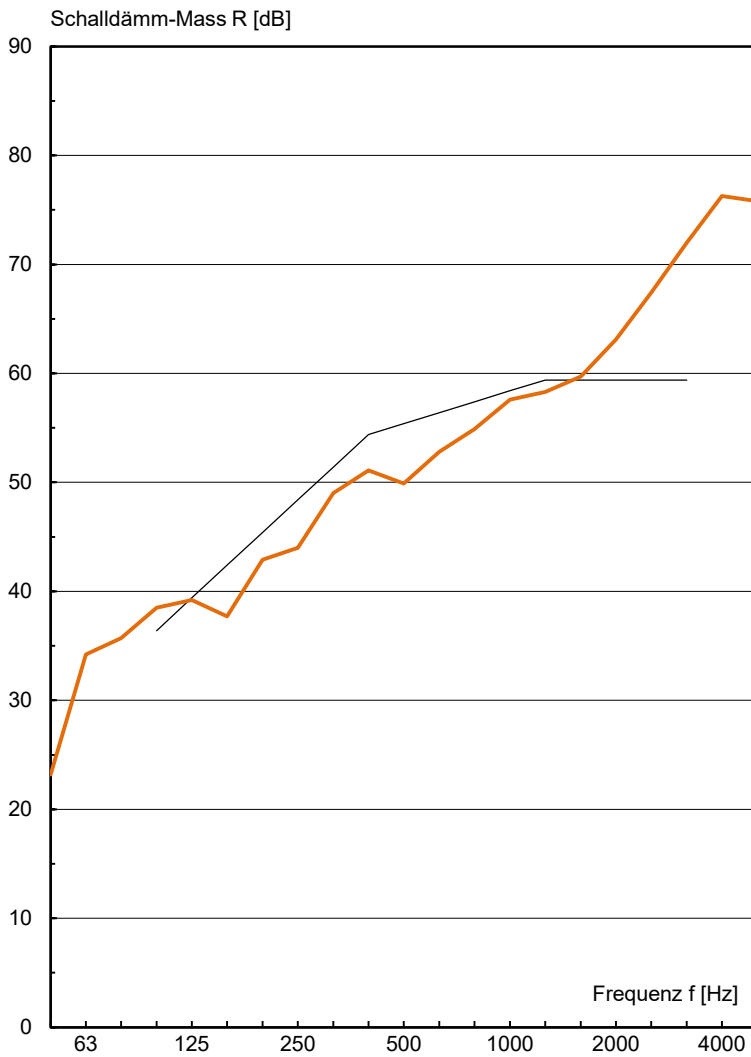

ift Rosenheim

R <sub>w</sub>	55.4
C <sub>100-3150</sub>	-1
C <sub>50-3150</sub>	-2
C <sub>100-5000</sub>	0
C <sub>50-5000</sub>	-1
C <sub>tr,100-3150</sub>	-5
C <sub>tr,50-3150</sub>	-10
C <sub>tr,100-5000</sub>	-5
C <sub>tr,50-5000</sub>	-10

f [Hz]	R [dB]
50	23.2
63	34.2
80	35.7
100	38.5
125	39.2
160	37.7
200	42.9
250	44.0
315	49.0
400	51.1
500	49.9
630	52.8
800	54.9
1000	57.6
1250	58.3
1600	59.7
2000	63.1
2500	67.4
3150	72.0
4000	76.3
5000	75.8

Messung: **4351**  
 Datum: 04.09.23  
 Prüffläche: 20.0 m<sup>2</sup>  
 Volumen: 62.0 m<sup>3</sup>  
 Abweichung: